

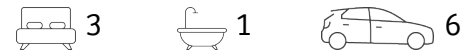

Sold By Theo Samos 0413 759 098

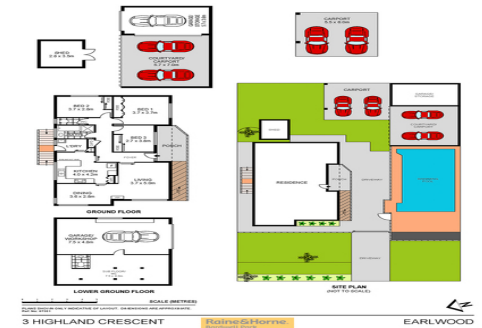

3 Highland Crescent, Earlwood

Sold

Land size approx. 663sqm with a wide 18.53m frontage

This prime parcel of land evokes exciting options for refurbishment, rebuild or development as a potential duplex site (SCTA). It's perfectly positioned in a quiet cul-de-sac in a prestige precinct that's close to Earlwood shopping village, schools and transport.

- Three generous sized bedrooms with built in wardrobes
- Large open living and dining areas, combustion fireplace
- Bathroom with separate tub and shower, 2nd w.c
- Original style kitchen with great bench space
- Under- house garage, great for storage and workshop
- Additional lock up garage plus carports for 4 vehicles
- Swimming pool, expansive and private backyard
- Situated approx. 1.1km to Turrella Railways Station
- Nearby parklands including Wolli Creek nature walk
- Excellent scope for enhancement

Property ID: 19920899

Property Type: House

Garages: 6

Theo Samos

0413 759 098

theo@rhbp.com.au