



You Won't Find Better Value in Berry



4



2



2

22 Huntingdale Park Road, Berry

\$870,000

Not only is this home priced to meet the market but it has also been designed to meet the needs of most families. 3 living areas, open plan design, alfresco entertaining with views to the mountains, a generous sized master suite with walk in robe and ensuite. The remaining 3 bedrooms have built in robes and are serviced by a lovely family bathroom. Internal access from the double garage makes life easy when unpacking the groceries and double gated access to the large back yard makes it a breeze to park the boat/trailer or caravan. Within walking distance to boutique shops, cafes, school and medical services, this home should be placed at the top of your list for inspection.

Property ID:	L962456
Property Type:	House
Garages:	2
Land Area:	683.0 sqm

Jacqueline Crapp

0429 104 011

jacqui.crapp@berry.rh.com.au

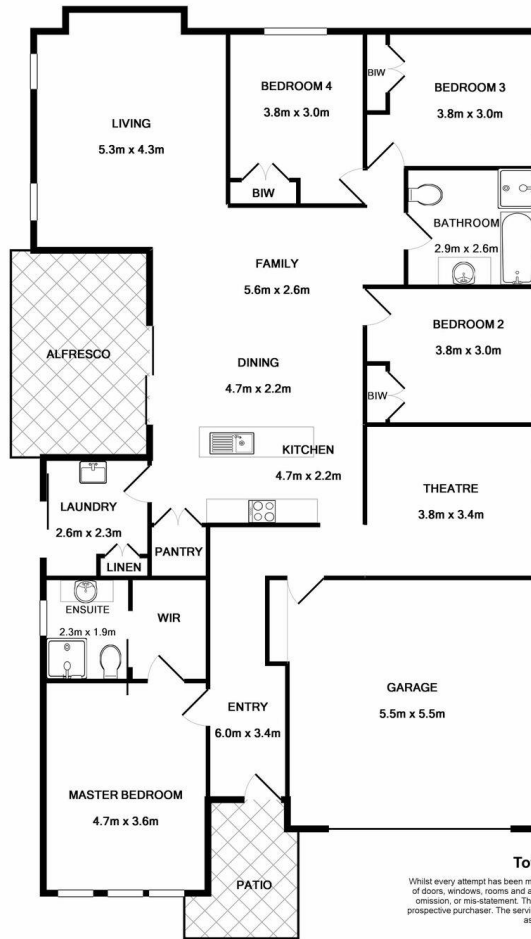

Total Floor Area 185sqm

Whilst every attempt has been made to ensure the accuracy of the floor plan contained here, measurements of doors, windows, rooms and any other items are approximate and no responsibility is taken for any error, omission or mis-statement. This plan is for illustrative purposes only and should be used as such by any prospective purchaser. The services, systems and appliances shown here are not guaranteed and are provided as to their operability or efficiency as given.

22 Huntingdale Park Road Berry