



**Very Affordable Well Presented Spacious
2 bedroom unit**



2



1



1

1/13 Phillip Street, Roselands

Sold for \$330,000 (Mar 28, 2019)

In neat original condition, this affordably priced ground floor apartment is packed with potential. Enhance to taste and enjoy as a first home or keep long-term as an investment property. Set back from the street in a well-maintained complex, this quiet setting offers exceptional convenience.

In a great location, the apartment is placed within a walk of Belmore South Public School, parks and transport, with handiness to the amenities of neighbouring Kingsgrove, Belmore and Lakemba.

- Original throughout with timber floors beneath the carpet
- Large lounge & dining area with a mirrored feature wall
- Covered balcony off living captures a sunny north aspect
- Tidy original kitchen opening to the lounge & dining area
- Two bedrooms, large main features a built-in wardrobe
- Neat tiled bathroom features a shower over the bath tub
- Registered parking space, shared laundry on same floor
- Updated & private complex with nice common grounds

Property ID: 20417978

Property Type: Unit

Building / Floor Area: 87

Open Parking: 1

Peter Kasas

0410 697 878

peter@bexley.rh.com.au

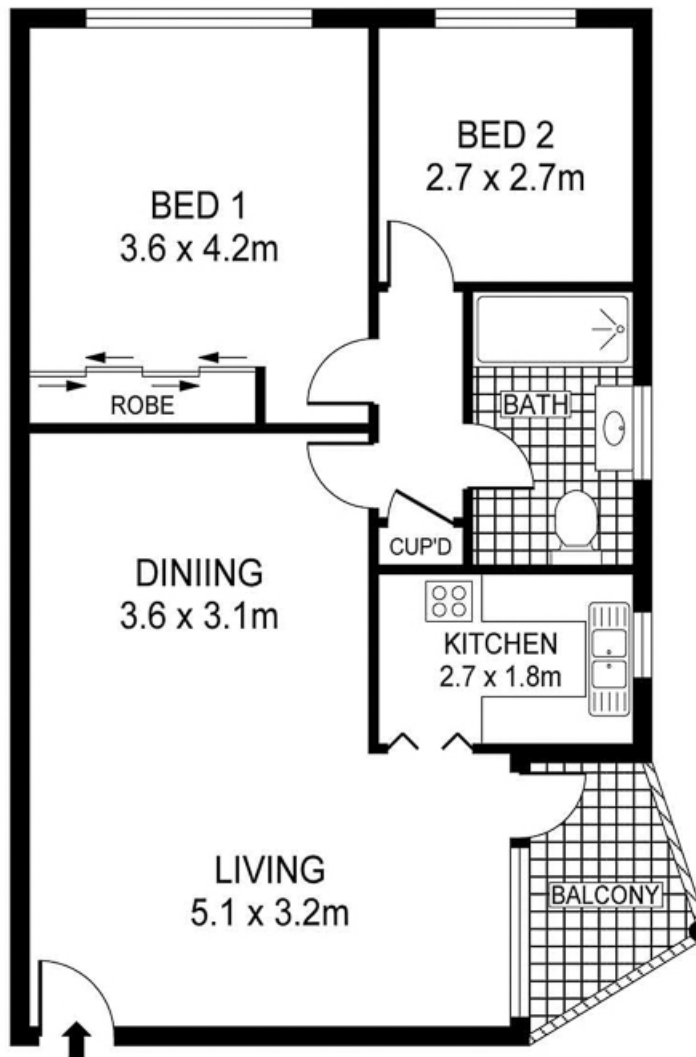

GROUND FLOOR

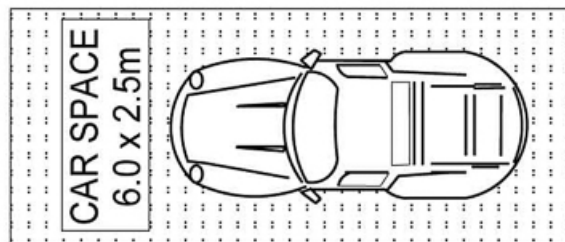

PLANS SHOWN ONLY INDICATIVE OF LAYOUT. DIMENSIONS ARE APPROXIMATE.
Ref. No. 70100

