



**STYLISH CITY FRINGE LIVING IN
STUNNING CONVERTED WAREHOUSE!**



14/252 Abercrombie Street, Redfern

Rented

This spacious apartment offers a peaceful home on Level 2, the top floor. It enjoys a contemporary design with open plan kitchen, dining and living area. The large rooftop terrace gives residents a haven to relax and take in the district view.

Located opposite Yellowmunde Park and Redfern Community Centre Playground, it is within a short stroll to eateries, city trains and Sydney University. A quick trip will see you to the CBD, Broadway shopping and Newtown.

Featuring:

- 2 bedrooms both with BIR
- New timber floor through bedroom to living room
- Modern U-shaped kitchen with dishwasher
- Spacious bathroom with full bath
- Internal laundry

Property ID: R801866

Property Type: Unit

Garages: 1

Corey Shen

0452032838

corey.shen@carlingford.rh.com.au

- Entry hall
- Security car space
- Well maintained, security building
- Boutique building of only 18 apartments

Unit 14, 252 Abercrombie St Chippendale

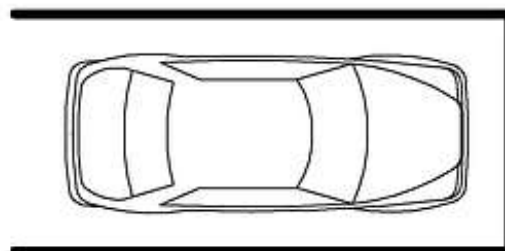
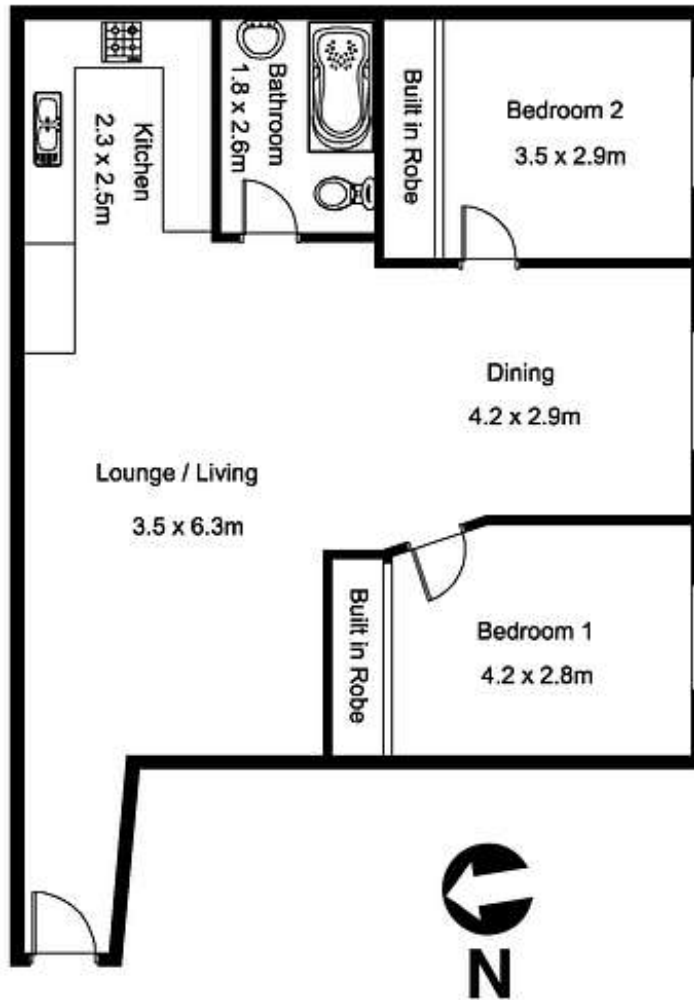

Secure Underground Carspace

Great care has been taken preparing this floorplan, however it should be used as a guide only. Layout and measurements to be considered approximate. This plan does not form part of any contract or title.