



Under Offer By Blake & Jason



4



2



1

26 Cumulus Circuit, Coomera

Sold for \$687,000 (Dec 11, 2023)

Still looking for that perfect mix of location and easy living for the family. Make sure this one is on your list this week – Great Location – Low Maintenance living and an outlook that is very rare. Step outside onto the timber deck, where you can enjoy the serenity of the backyard that backs onto the lush Finnegan Park. With convenience in mind, IGA Coomera is just a stone's throw away, ensuring that daily necessities are within easy reach. Embrace the tranquility of this delightful home, offering the perfect blend of comfort and community living.

Outstanding Features include

- Master bedroom with ensuite
- 3 additional great sized bedrooms with built-in robes
- Split system air conditioners & ceiling fans throughout
- Large timber deck
- Open plan living
- Single lockup garage with car space on driveway

Property ID:	L791914
Property Type:	House
Garages:	1
Land Area:	279.0 sqm

Jason Read
0404493690
Jason.Read@coomera.rh.com.au

- Next door to Finnegan Park & Coomera IGA
- 279 square meter block
- Built in 2015
- Within Coomera Rivers State School catchment area
- 4 min walk to Coomera Playschool Early Learning
- 5 min walk to Bus stations

Positioned on the doorstep of unsurpassed growth, this outstanding property will allow easy access to the facilities that Coomera is now getting a great reputation for, such as an unprecedented amount of infrastructure being added including Costco Coomera which is now open & the future Coomera Hospital set to open in late 2027. Add the 600 million-dollar Coomera Westfield shopping development 10 minutes away offering restaurants, a play center, Event Cinemas & so much more. Surrounded by established amenities and under-construction shopping precincts. Capitalizing now is the only way to get in before prices rise! Gainsborough Greens golf course is on your doorstep plus ocean access to Moreton Bay from Jacobs Well or a boat ramp to the Coomera River simply 10mins away a wonderful escape for boating & fishing for your weekends.

Disclaimer: In preparing this information, we have used our best endeavors to ensure that the information contained herein is true and accurate, but accept no responsibility and disclaim all liability in respect of any errors, omissions, inaccuracies, or misstatements that may occur. Prospective buyers should make their own enquiries to verify the information contained herein.

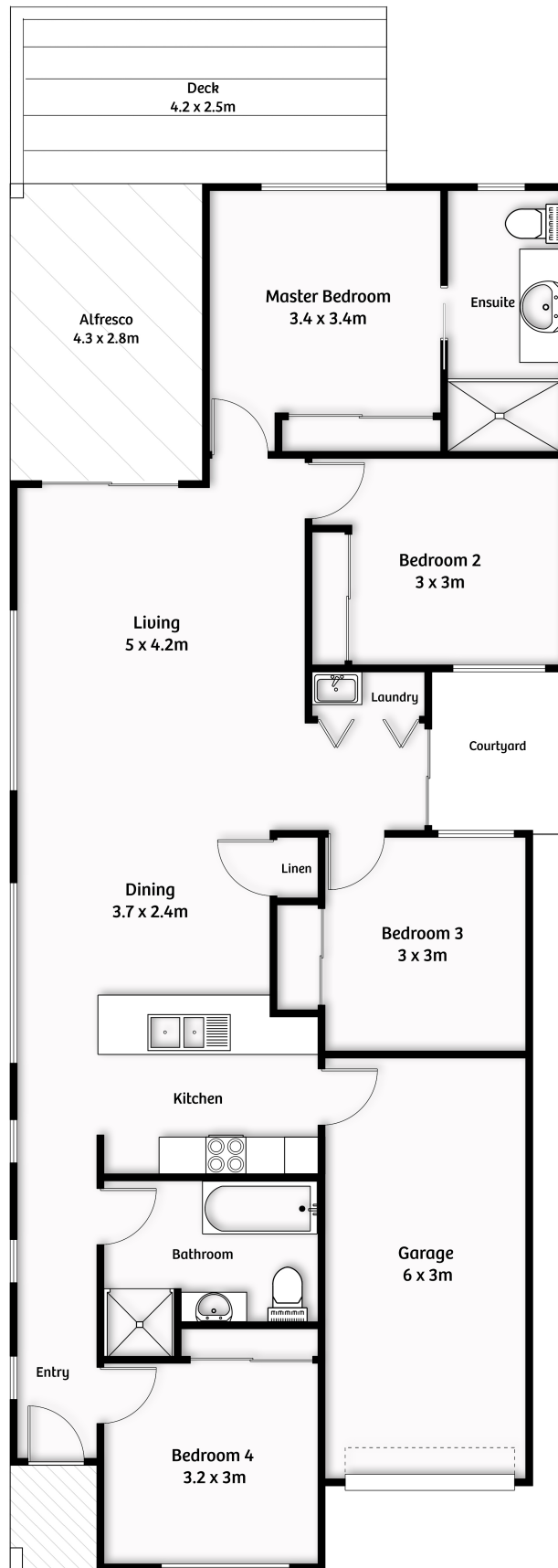

Total floor area approx : 148m²

Raine&Horne®

26 Cumulus Circuit, Coomera

Whilst every attempt has been made to ensure the accuracy of the floor plan contained here, measurements of doors, windows, rooms and any other items are approximate and no responsibility is taken for error, omission or mis-statement. This plan is for illustrative purposes only and should only be used as such by any prospective purchaser.

