



Opportunity Knocks Only Once



4



2



2

6 Nickel Street, Pimpama

Sold

Looking for that opportunity to get into the market – Look no Further. This is perfect for those wanting an easy lifestyle with the convenience of the surrounding facilities of Pimpama. With an open-plan living area plus an alfresco area overlooking the rear yard, this is the perfect first home. Start your family dream here and make your enquiries today.

Property Features Include:

- 4 Bedrooms
- Master with built in wardrobe and ensuite
- 2 bathrooms
- Air conditioning in the living room
- Ceiling fans throughout
- Open plan living and dining
- Carpeted throughout

Property ID: L4103336

Property Type: House

Garages: 2

Land Area: 418.0 sqm

Jason Read

0404493690

jason.read@coomera.rh.com.au

- Caesar stone benchtops
- Gas Cooktop
- Stainless steel appliances
- Dishwasher
- Outdoor alfresco area
- Internal Laundry
- Double lock up garage
- Fenced Yard
- Built in 2011
- 418m2 block

Life is easy with shops close by and schools within walking distance. If four wheels are more your preference of transport then Pimpama is positioned to give access to either Brisbane or the Gold Coast for the weekday commute and the planned \$192.6 million M1 Pacific Motorway Exit 41 and Exit 49 upgrades will make that commute shorter and faster, not to mention the State Government has confirmed the location of a new Pimpama Rail Station on the Gold Coast Line as well as a new Police facility with Queensland Fire and Emergency Services, construction of the new \$3 million QFES facility is expected to start later this year which is a sign of the growth recognized and planned for the future of Pimpama!

As you can see Pimpama is the Booming suburb of the Northern Gold Coast and just perfect for the weekends and definitely a family-friendly suburb! Your family is well catered for with numerous local schools plus parks and grounds for the weekends. Pimpama is now enjoying high demand for offering a quality lifestyle. Our suburb is now offering 2 shopping locations with the new Pimpama City Centre and Pimpama Junction offering all your shopping needs. Add the 600 Million-dollar Coomera Westfield shopping development 10 minutes away. Surrounded by established amenities and under construction shopping precincts, capitalizing now is the only way to get in before prices rise! Gainsborough Greens golf course is on your doorstep plus ocean access to Moreton Bay from Jacobs Well within 10 minutes away.

Pick up the phone and book an inspection with Bailey Hyland or Jason Read today to avoid missing out as this property will not last long!

6 Nickel Street Pimpama

4 2 2 land: 418m²

internal: 153m² | external: 15m² | total: 168m²

Raine & Horne

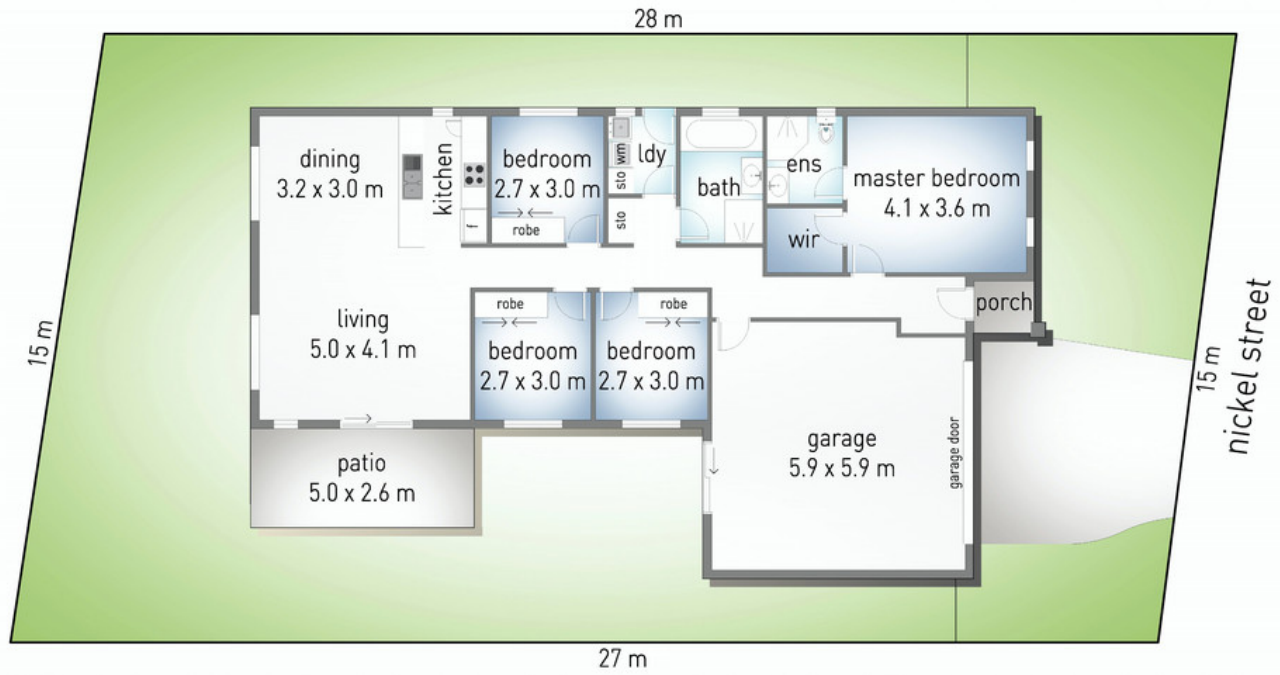

realimage media
PROPERTY PHOTOGRAPHY • DIGITAL MEDIA

Dimensions are approximate. All information contained herein is gathered from sources we believe to be reliable. However we cannot guarantee its accuracy and interested persons should rely on their own enquiries.

