

Charming first home or investment in sought after location



1



1



1

114/72 Henrietta Street, Waverley

Sold

Privately positioned in a coveted enclave between beautiful Bronte Beach and the vibrant village cafes and shops of Charing Cross, this apartment is the perfect first start, presenting a great opportunity as an entry into the Eastern Suburbs property market or an ideal investment.

Capturing district ocean views and set amid a beautiful leafy communal garden oasis, this apartment has a wonderful sense of peace & seclusion. Featuring a sunny glass-embraced north-east facing bedroom with balcony, open-plan living and dining, separate kitchen space, bathroom and off-street parking.

- Stunning natural light, garden and ocean outlook
- Scope to add your own cosmetic touches if desired
- Open plan living/dining with separate kitchen space
- North east facing bedroom with balcony, leafy views
- Off-street parking on title, share coin-operated laundry

Property ID: 20706873

Property Type: Apartment

Garages: 1

Paula Simoes

0499 090 929

paula@rhdb.com.au

- Communal gardens, walk to Bronte & Tamarama beaches
- Located close to Westfield and Bondi Junction transport
- Ideal investment or perfect first start into the market

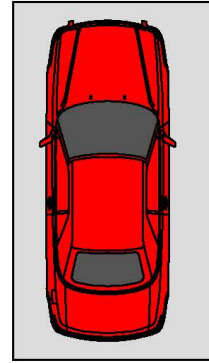
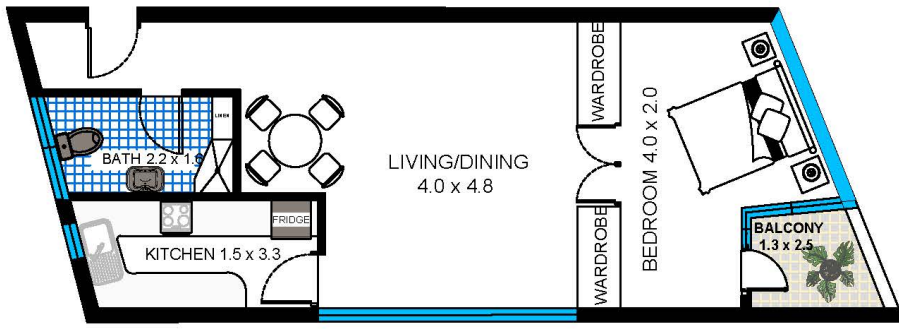

114/72 HENRIETTA ST, WAVERLEY

This diagram is for illustrative purposes only. Dimensions shown are approximates only. Prospective buyers should rely on their own enquiries.

