

Purse Pleaser on 1031m2



2



1

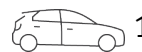

1

94 JOHN STREET, Rosewood

\$239,000 neg

An amazing amount of potential is yet to be explored with this property and it will excite and invigorate owner occupiers and investors alike and we encourage all interested buyers to immediately inspect as this property must be sold ASAP!

- 2 Street access and 1031m2
- Bundles of character
- 2 good sized bedrooms
- Enclosed front verandah
- Very functional kitchen with abundant storage
- Separate dining and family rooms
- Generous bathroom
- 1031m2 near level, useable yard

Property ID:	L777416
Property Type:	House
Garages:	1
Land Area:	1031.0 sqm

Richard Bird
0448 418 518
richard.b@ipswich.rh.com.au

- Easy wide side access
- Walking distance to the town centre, rail and schools

Rosewood a very popular lifestyle location, offering a peaceful family-friendly atmosphere, convenient access to Sporting clubs, Rosewood CBD, and wide range of facilities including shopping centres, café's and retail options. The area is close to a variety of schools that are well service by public transport.

Internal 84m² External 947m² Total 1031m²

94 John Street, **Rosewood**



2 x 1 x 1 x

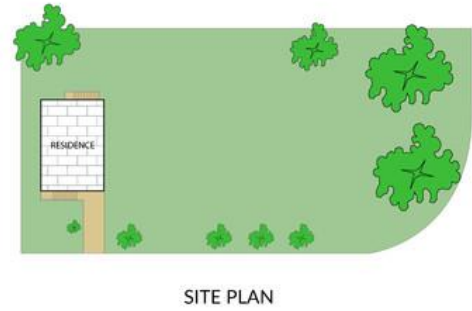
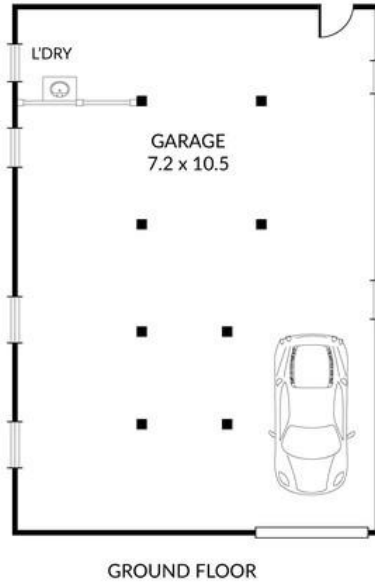
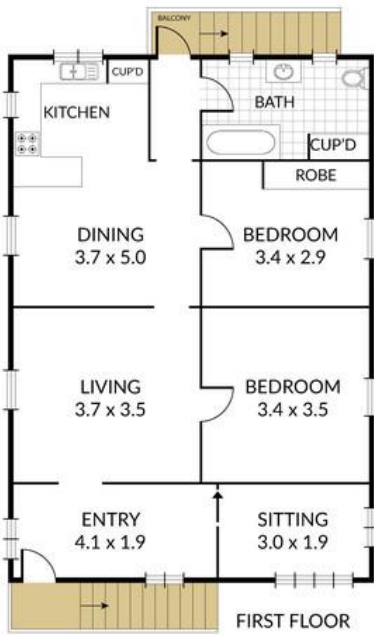

NOTE: Every precaution has been taken to verify the accuracy of the above details. However, prospective purchasers are advised to make their own enquiries.