



MUST SELL!! CHARMING 2 BEDROOM 2 STOREY VILLA - FURNISHED - PRICED TO SELL! -...



2



2



1

120/121-137 Port Douglas Rd (Reef Resort), Port Douglas

\$165,000

This charming two bedroom two bathroom townhouse delivers the full tropical experience. Certain furniture comes with the villa including a new fridge and washing machine. This is one of the best priced villas in the resort as the Owner is committed to selling for family reasons. For investors the property would lease for \$370 to \$400 per week. Being block built and having double glazed windows means the villa is nice and quiet inside. It's conveniently positioned within the resort being close to the gymnasium, lap pool and main lagoon pool (pictured) and with no villas behind the property there's a lovely leafy tropical outlook from the large balcony and back patio. Anyone interested in an investment property or keeping this as your own delightful holiday home should have a look as soon as possible.

Other features include;

- Resort facilities for owners and guests include; 3 lagoon pools, lap pool, gymnasium, tennis courts, onsite restaurant and bar.
- Comes with it's own carport
- Air-conditioning & ceiling fans throughout.

Property ID:	L488732
Property Type:	Unit
Building / Floor Area:	113
Carports:	1

Greg Brown

0472525250

greg.brown@portdouglas.rh.com.au

- Onsite management if you'd like to holiday let the property and use it for your own holidays.

Inventory list;

KITCHEN:

Refrigerator

Microwave

Knives

Forks

Plates

Glasses

LOUNGE ROOM:

3 x Piece lounge set

Table

Chairs

Cabinet

Television

LAUNDRY:

Washing Machine

Dryer

BEDROOM 1:

Queen Bed

2 x Side Tables

2 x Bed Lamps

BEDROOM 2:

2 x King single beds (which zip together)

2 x Side Tables

2 x Bed Lamps

Please call Greg Brown on 0472525250 to arrange a private inspection.

Raine & Horne®



Please Note: All care has been taken to ensure the accuracy of this plan. However, it is not a surveyed plan therefore dimensions and icons used are estimates only. This plan is for illustrative purposes only and should be used as such by any prospective buyer.

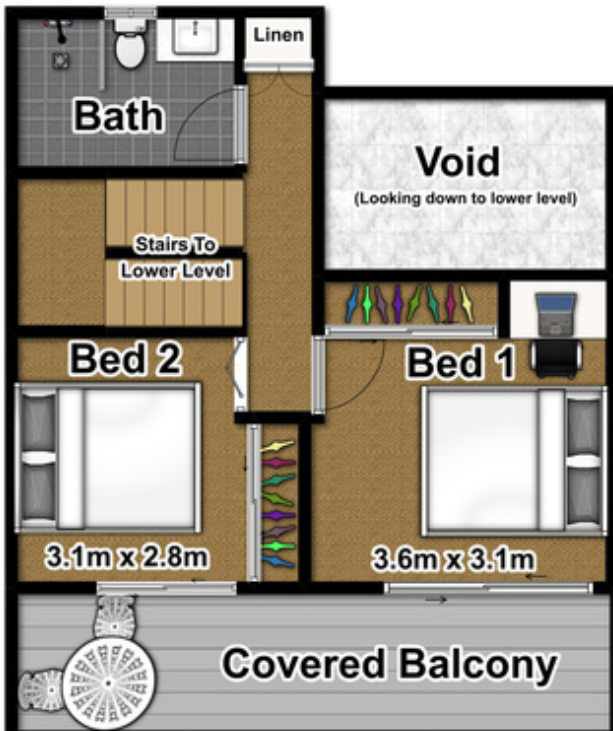

Upper Level



Lower Level