



Affordable Home in a Convenient Location



2



1



3

211 Christo Road, Waratah West

Sold

Neat as a pin and set on a 518.5 allotment on the high side of the street this appealing clad and tile home presents comfort, convenience and great value in the current market and offers a fantastic opportunity for first home buyers and astute investors seeking a sought-after lifestyle at an affordable price.

Welcomed by high ceilings and pleasant light-filled interiors the home flaunts a lovely lounge room open to front sunroom and two generous bedrooms serviced by an updated bathroom with wc.

The property boasts a separate dining room with gas fireplace adjoining a pleasant functional galley kitchen with natural gas cooking. The kitchen is suitably positioned at the rear of the property and provides seamless

flow to the covered patio and sunny North facing rear yard. The property is complimented by drive access to a rear auto garage and double carport. This little gem is sure to tick a lot of boxes, be quick to inspect this

one it won't last long.

- Value buying Clad & Tile home

Property ID:	L960858
Property Type:	House
Garages:	1
Carports:	2
Land Area:	518.5 sqm

Trudy Zeug

0411 843 051

Trudy.Zeug@newlambton.rh.com.au

- Positioned on 518.5 m2 block, high side of street
- Light-filled interiors, high ceilings
- Good size lounge room open to sunroom
- Two generous bedrooms, main with robe
- Updated bathroom with separate toilet
- Separate dining room with gas heating
- Galley kitchen with gas cooking, ample bench & cupboard space
- Natural Gas + Air conditioning unit in lounge room & dining room
- Internal laundry + storage
- Rear covered patio
- Lovely north facing rear yard
- Drive access to single auto garage and double carport
- Close proximity to public transport links, schools, Waratah Village, Lambton shops, pool & parkland
- Minutes to Newcastle University, Calvary Mater Hospital
- Great First Home or Investment

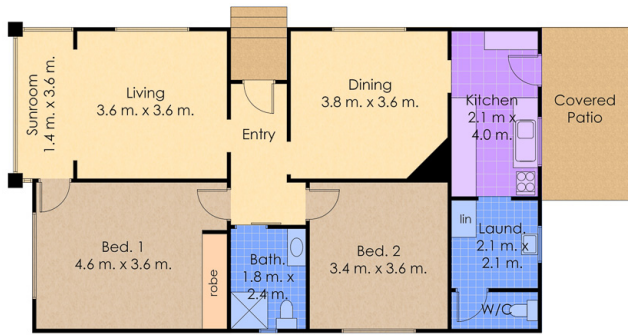

Floor Plan
 Approx. Internal Floor Area: 112 sqm.

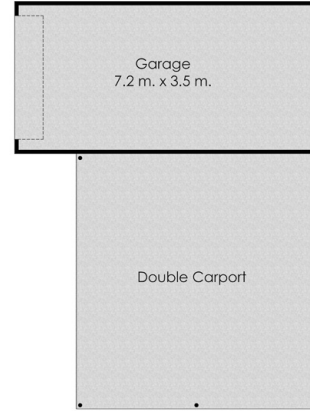

Site Plan
 Not to Scale

Raine & Horne 211 Christo Rd,
 Waratah West

0 m. 1 2 3 4 5



Measurements and direction of north are approximate and are to be used as a guide only.