



CHIPPENDALE
307/82 Abercrombie Street

1 

The ultimate lock up and leave lifestyle pad

Auctioned for \$558,000 (Nov 15, 2018)

Positioned on the third floor of Chippendale's iconic warehouse conversion Tribeca, this exceptional apartment delivers the quintessential city fringe lifestyle pad. A haven of contrasts, sleek contemporary styling meets industrial verve where accents of the timber and steel features of the original building have been preserved.

Set back in the building its light drenched and spacious, with a floorplan presenting as one expansive open plan with the living and dining merging with the generous bedroom space and kitchen. A wall of glass opens to access the balcony and to frame the leafy district vistas and the urban outlook that is on show. The kitchen is a sleek gourmet space finished with a gas cooktop.

This quality residence includes a spacious designer bathroom, concealed laundry, security entry, lift and the use of a shared gym and sauna. A large central atrium in the building is a unique feature and welcomes in the natural light. Positioned back from the road, it's a desirable haven that enjoys a superb array of laneway cafes, pubs and eateries surrounding it and is a stroll to the bus, rail, UTS, Broadway and Central Park shopping and Sydney University.

Property ID: 19866087

Property Type: Studio

AGENT

Duncan Gordon

 0414349669

 duncan@rhnewtown.com.au

Love your lifestyle

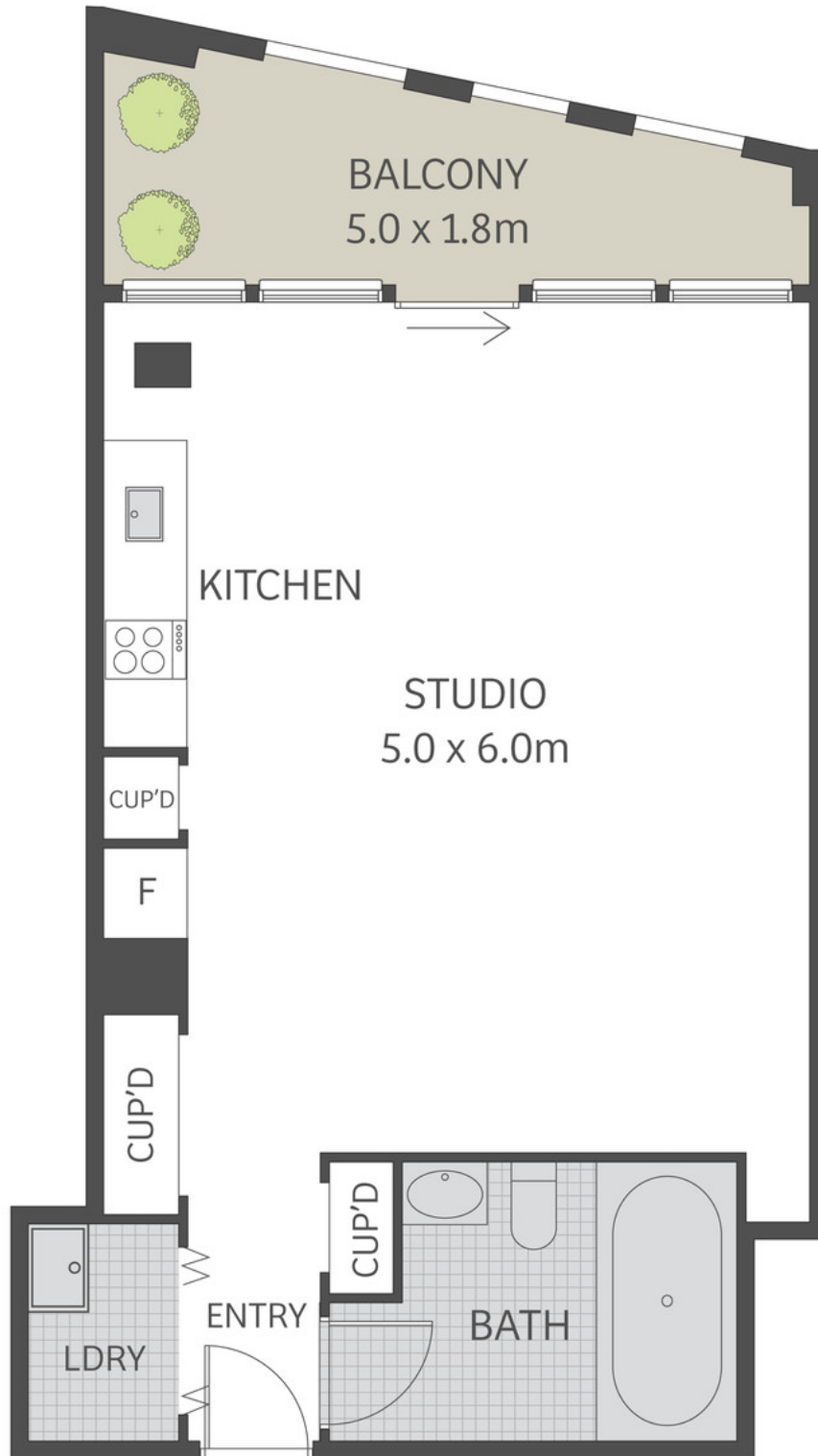

LEVEL THREE

This floor plan is for marketing purposes and is to be used as a guide only. All efforts have been made to ensure its accuracy although interested parties are urged to rely on their own enquiries.