



WEST NOWRA
2 Tummell Close

4  1  2 

MUST BE SOLD!!!

2 Tummell Close is a neat and tidy brick and tile, 4 bedroom, 1 bathroom home with a double garage.

The home would be perfect for a first home buyer, it has great street appeal. The home is in original but good condition with a large living area leading to the kitchen with a bay window to let in natural light.

The bedrooms are generous in size, with 3 having built-in robes and a 3-way bathroom. There is an undercover living area and a good sized shed in the yard.

With a fantastic location in a quiet cul-de-sac, it's only a few minutes from the CBD.

For an inspection phone Linda Edwards 0403 437 266.

Property ID	18848181
Property Type	House
Garages	2

AGENT



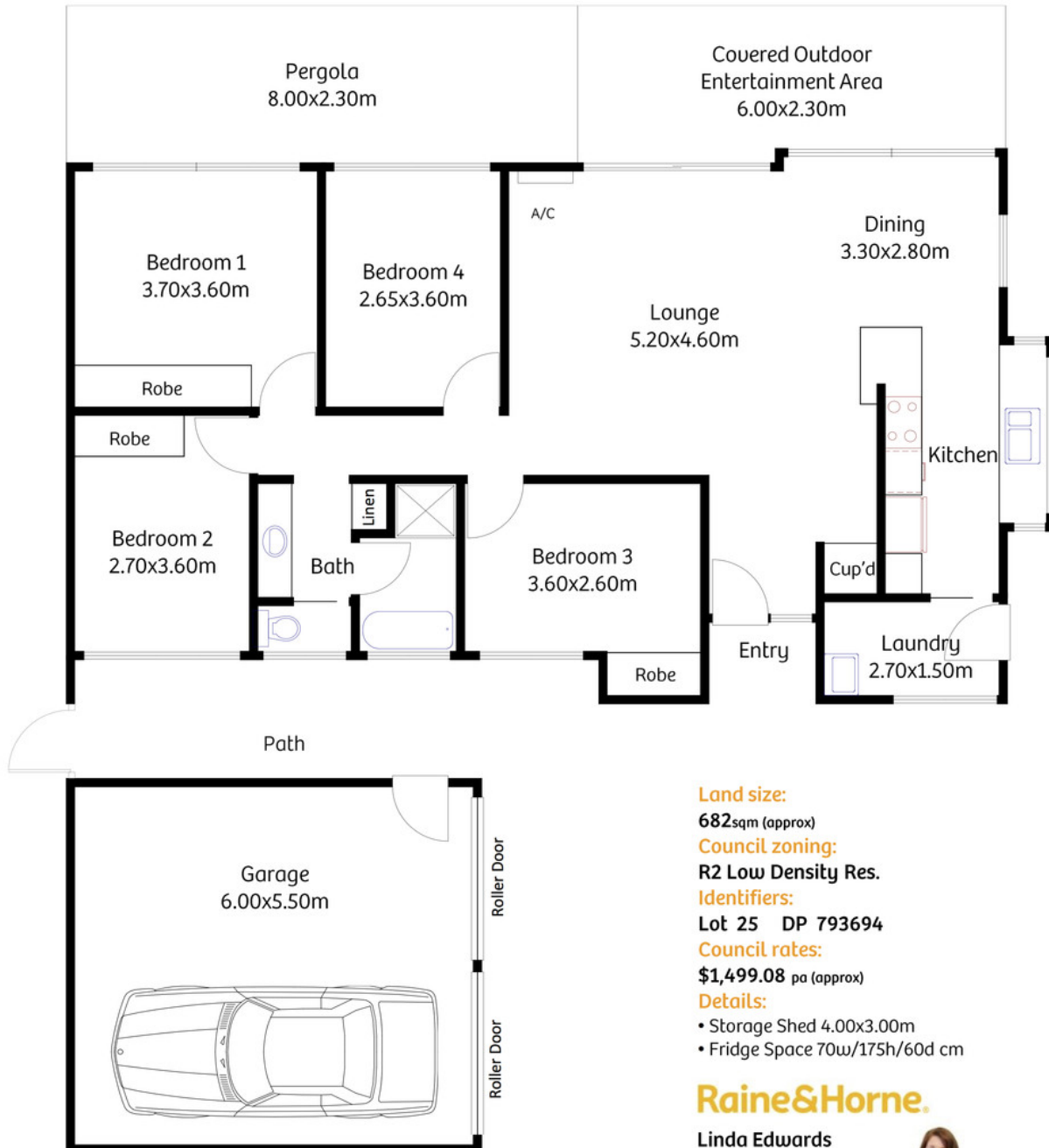

Land size:

682sqm (approx)

Council zoning:

R2 Low Density Res.

Identifiers:

Lot 25 DP 793694

Council rates:

\$1,499.08 pa (approx)

Details:

- Storage Shed 4.00x3.00m
- Fridge Space 70w/175h/60d cm

Raine&Horne.

Linda Edwards

Sales

0403 437 266

4423 4600

linda.edwards@nowra.rh.com.au

