



Sold by VIJETH SHETTY (0432 407 840)
FOR \$389,000



2



1



1

18/1 Hyde Park Ave, Craigieburn

Sold for \$389,000 (Feb 07, 2019)

Sold by VIJETH SHETTY (0432 407 840) FOR \$389,000

Right at the heart of Craigieburn, in one of the most sought out location only a short distance to all that school, shops and transport stands this immaculately kept townhouse. Boasting 2 large bedrooms serviced by a central upstairs bathroom and a spacious light-filled kitchen with attached meals and family areas. Also comprising heating & cooling, ample storage, sunny courtyard and private rear access through the single carport with roller door. Currently leased, this is the perfect first home or addition to your investment portfolio.

- Spacious well-appointed kitchen
- 2 large bedrooms
- Central bathroom
- Superb location (schools, shops & transport)
- Secure rear access

Please contact Vijeth Shetty 0432 407 840 for further details

Property ID: 19692742
Property Type: Townhouse
Garages: 1

Due Diligence Checklist – for home and residential property buyers –
<http://www.consumer.uic.gov.au/duediligencechecklist>.

DISCLAIMER: All stated dimensions are approximate only.

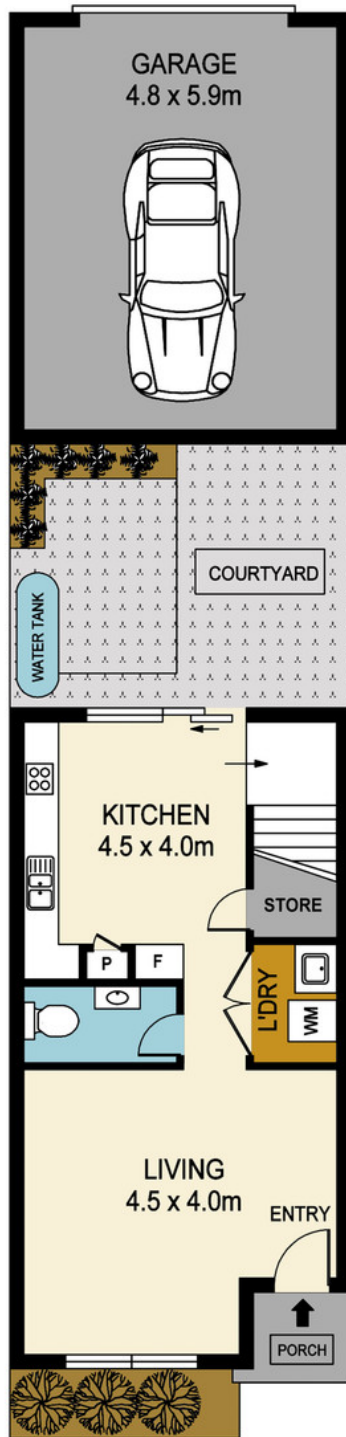

GROUND FLOOR

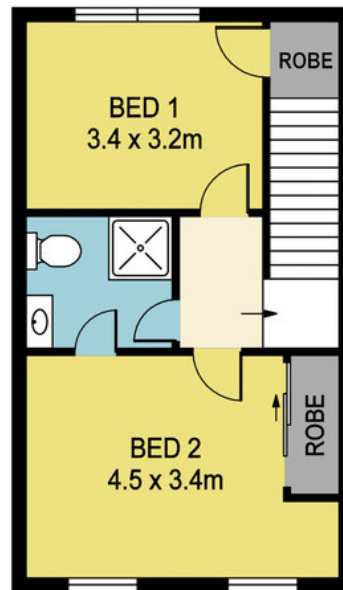

FIRST FLOOR

18/1 HYDE PARK AVENUE, CRAIGIEBURN,

DISCLAIMER

PLANS SHOWN ARE FOR MARKETING PURPOSES ONLY, ALL DIMENSIONS ARE APPROXIMATE AND NOT TO SCALE. THEY ARE SUBJECT TO ERRORS AND INACCURACIES AND NO LIABILITY WILL BE ACCEPTED. INTERESTED PARTIES SHOULD MAKE THEIR OWN INQUIRES.