



ORFORD  
7606 Tasman Highway

1 

1 

## EAST COAST BEAUTY ON THE PROSSER RIVER

Sold for \$235,000 (Jul 10, 2018)

Quiet cottage situated on the banks of the Prosser River. This one bedroom cottage faces North enabling it to capture all day sun. The property sits on the edge of bushland and has partial views of the Prosser River.

The home has open kitchen, dining and lounge area and has a wood heater and reverse cycle heat pump. There is one large bedroom in the main building but a separate sleep out outside has two rooms which could be used as bedroom, studio or office. Back inside the cottage the bathroom has a vanity, large shower and incorporates the laundry.

There are numerous outbuildings (sheds) and plenty of room to add a large garage. This property would suite a vast array of people from a retired couple to somebody after a holiday shack or Airbnb.

With the Prosser River now having a lot of work done on the entrance to it and beyond making access to Spring Bay and the Mercury Passage & Maria Island accessible to large runabouts. The calm waters of the Prosser River also make it the perfect spot to kayak up the river and enjoy the serenity of the area.

This home is waiting for a new chapter so be quick to arrange an inspection of this East Coast Beauty. Call Danny or Debbie to arrange a viewing.

Property ID:	19284118
Property Type:	House
Building / Floor Area:	60

### AGENT

**Danny Boon**

 0427 010 300

 danny.boon@sorell.rh.com.au

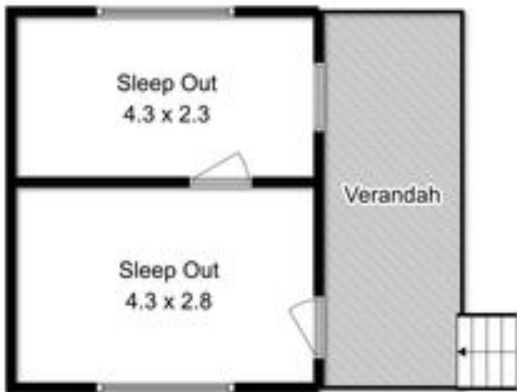

This floorplan is a sketch for illustration only  
Not to scale  
All measurements are internal and approximate  
Produced by open2view.com for Raine & Home Sorell