



OXLEY PARK
5/32 Canberra Street

3 2 2

SOLD BY PETER DIAMANTIDIS 0404 051 702!!

Sold for \$518,000 (Sep 14, 2018)

Very rare to find a NEWLY CONSTRUCTED townhouse with a large courtyard!

Positioned in a quiet street and a small block of 5 townhouses, this property would be ideal for a first home buyer who is trying to get into the market!

Features include:

- 3 spacious bedrooms
- Built in robes to all bedrooms
- Ensuite to the main bedroom
- 3rd Toilet downstairs
- Vertical blinds throughout
- Open plan living with porcelain flooring
- Stone benchtops and stainless steel appliances
- Lock up garage + extra allocated car space
- Located at the rear on the complex with the largest backyard

Property ID:	19430820
Property Type:	Townhouse
Garages:	1
Open Parking:	1

AGENT

Peter Diamantidis
 0404051702
 peter.d@stmarys.rh.com.au

Contact Peter Diamantidis for further information on 0404 051 702

5/32 Canberra Street, Oxley Park

Raine & Horne®

Please note:
Floorplan measurements are a guide only.
All dimensions are approximate in their distance and volume.

210 Queen Street
St Marys, NSW 2760
02 9623 5666

Rear

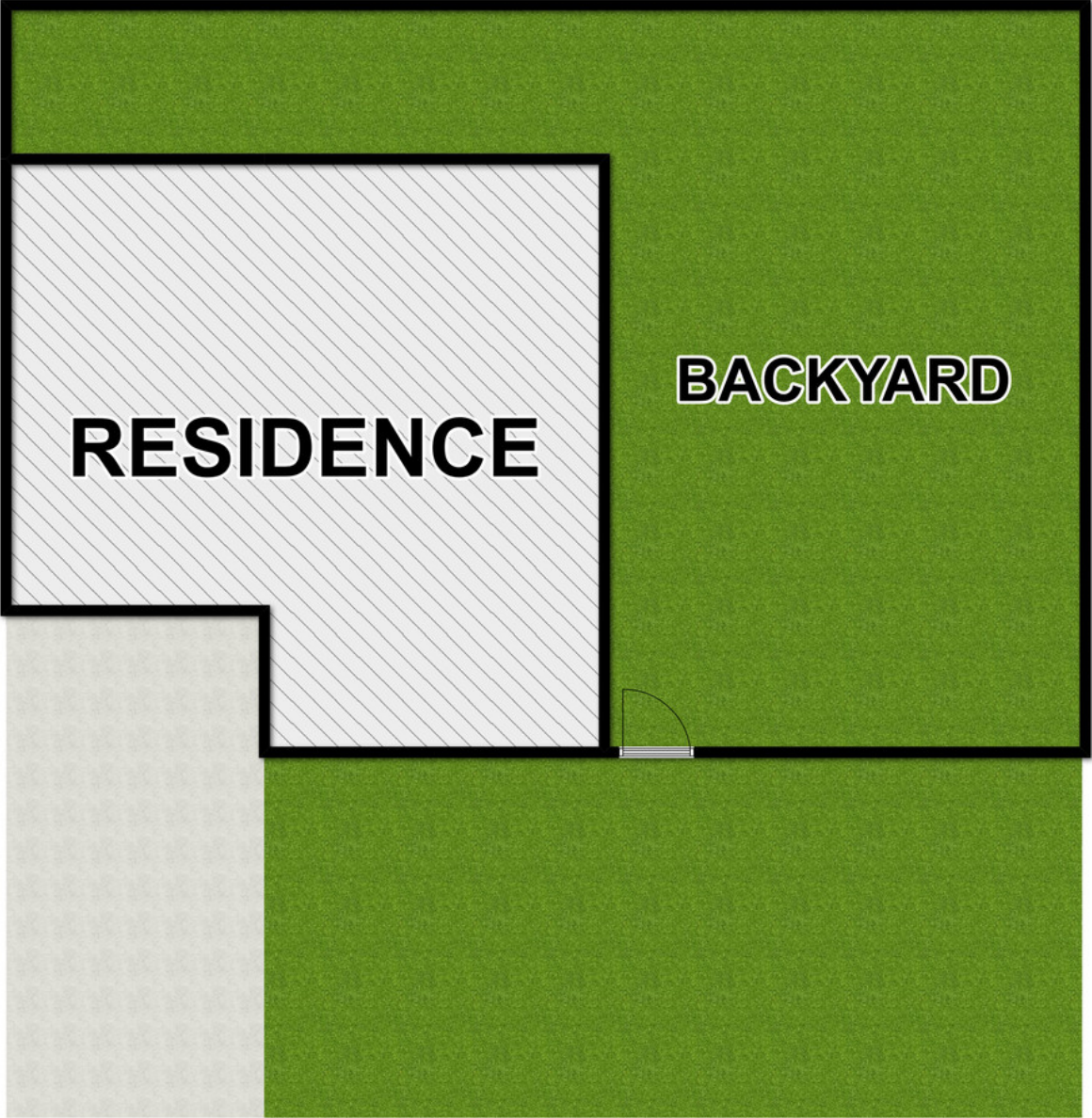

Front



Peter Diamantidis
Sales Manager
0404 051 702
peter.d@stmarys.rh.com.au



-  3
-  2
-  1