



Stage 4A Price List

LOT	ADDRESS	LAND (m ²)	LAND PRICE
238	KIBBY CIRCUIT	747	\$ 155,000
239	KIBBY CIRCUIT	685	\$ 140,000
241	LEAK COURT	779	\$ 159,500
242	LEAK COURT	825	\$ 169,500
243	LEAK COURT	631	\$ 139,500
245	KIBBY CIRCUIT	638	\$ 139,500
247	KIBBY LANE	607	\$ 139,000
249	KIBBY LANE	542	\$ 135,000
250	KIBBY CIRCUIT	625	\$ 142,500
251	KIBBY CIRCUIT	630	\$ 142,500

Land For Sale

House & Land Packages Available with Oakford Homes

For more information please contact
Nick Grosvenor 0439 845 974 RIA 166174
Raine & Horne Strathalbyn

Prices & availability of land subject to change without prior notice. Excludes fencing and retaining walls (if required).
Details current as at 15/08/2019.
Allotment sizes and dimensions, locations and size of easements may vary slightly from the final plan.
Pipers Crest is located in the Adelaide Hills suburb of Strathalbyn.

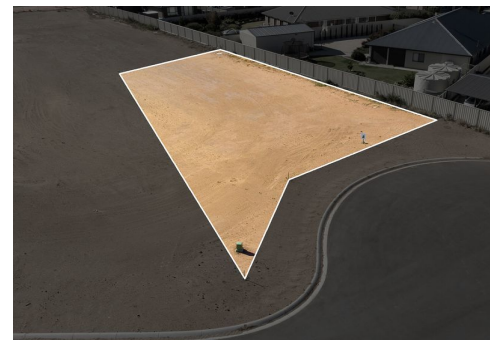

STRATHALBYN Lot 241 Leak Court

"Pipers Crest"- The Middle Creek Reserve

Welcome to Strathalbyn's premier land estate, prepare to fall in love. The time has come to unveil "The Middle Creek Reserve". This fantastic offering contains 20 premium allotments with uninterrupted views over the tranquil Middle Creek. This landmark release is positioned within a stone throw to the stunning "Pipers Crest" parkland facilities and only a 15-minute walk to Historic High Street. Each of the premium allotments are ready to build on with SA water, sewer, power and NBN connections available. Build the dream in one of the best positions Strathalbyn has to offer.

"Pipers Crest"- Highlights

- Master planned design
- Wide open spaces
- Glorious parklands
- Picturesque lake
- Lush tree lined streets
- Fenced Tennis Court
- Playground
- Dual undercover dining areas
- BBQ Facilities

Property ID:	L448262
Property Type:	Land
Land Area:	779.0 sqm

AGENT

Nick Grosvenor

📞 0439 845 974

✉️ nick.grosvenor@strathalbyn.rh.com.au

- Meandering walking trails leading to the town centre

Location

- 3-5 Minutes to the township centre

- 15 minutes to Mt Barker

- 30 minutes to Murray Bridge

- 30 Minutes to the South Coast

- 45 Minutes to Adelaide

*Please note: Titles are yet to be issued (settlement proposed August 2019)