



& SOLD by Blake Gray & Craig Fisher



2



2



2

10/1A Woodbury Park Drive, Mardi

Sold for \$442,500 (Jul 19, 2019)

& Online marketing views: 1,360

& Qualified buyers inspected the property: 12

& Offers made: 3

& Sale Price: \$442,500

Call Us Today On 0488 007 205 !!!

Award-Winning Real Estate Sales Force

Selling & Leasing The Central Coast

E & OE. Please note that all information herein is gathered from sources we believe to be reliable, however, we cannot guarantee its accuracy and interested parties should rely on their own enquiries.

Property ID: 20671002

Property Type: House

Garages: 1

Carports: 1

Blake Gray

0448822123

blake.gray@toowoombay.rh.com.au

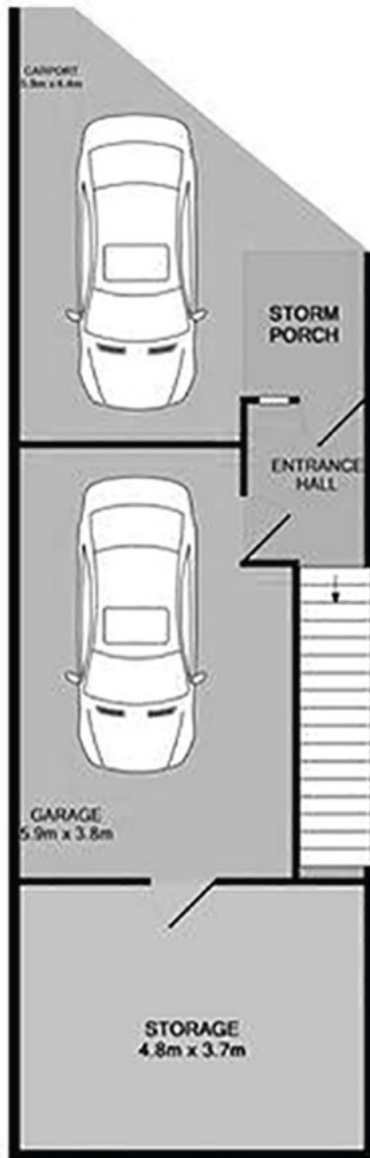

Lower Level
 67.8 SQ.M.
 730 SQ.FT.



Mid Level
 53.2 SQ.M.
 573 SQ.FT.

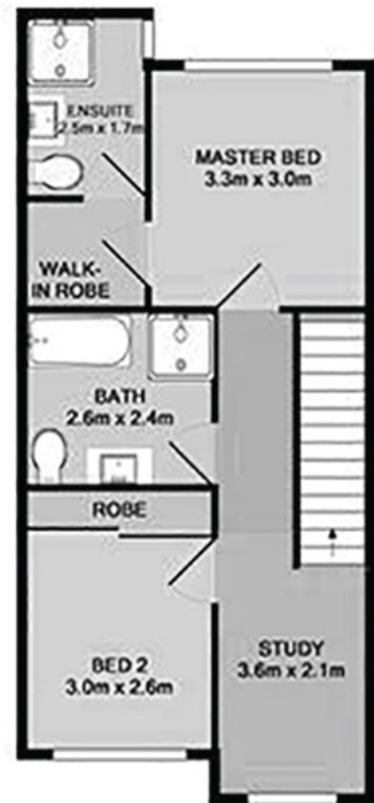

Upper Level
 46.2 SQ.M.
 497 SQ.FT.

Total Approx. Floor Area 167.2 SQ.M.

10/1a Woodbury Park Drive, Mardi NSW

Disclaimer: This floor plan including furniture, fixture measurements and dimensions are approximate and are for illustrative purposes only. The information in this document has been obtained from sources we believe to be reliable; however, we cannot guarantee its accuracy. You are advised to carry out your own investigations.