



TIMELESS COUNTRY STYLE



3



3



4

7 Greenview Close, Ulladulla

Sold for \$980,000 (May 20, 2019)

This quality home on 2.5 acres is conveniently located between Milton and Ulladulla and boasts spectacular escarpment views. The dining room and superb country timber kitchen with SMEG appliances open onto a covered timber entertaining deck with access to the private solar heated salt water pool. Snuggle up by the slow combustion fireplace in the lounge room which opens onto a sunny verandah enclosed in glass to make the most of the bush and garden views. The home features three large bedrooms, master with walk-in robe and en-suite. There is a large double garage with an attached tandem garage with a large high carport offering room for the boat and/or caravan. A kitchenette and bathroom allows you to work comfortably from your garages or use as guest accommodation. With fruit trees, including citrus, stone fruit, figs and grape vines, as well as rose gardens and established ornamental trees, this property is perfect for a family to enjoy everything the region has to offer. There's even room for a horse!

Five minutes to Ulladulla Shopping Centre, Milton village, surf beaches and just a short walk to Cupitt's Winery.

Property ID: 18747966

Property Type: AcreageSemi-rural

Garages: 3

Carports: 1

Ben Pryde

0410 324 209

bpryde@rhmolymook.com.au

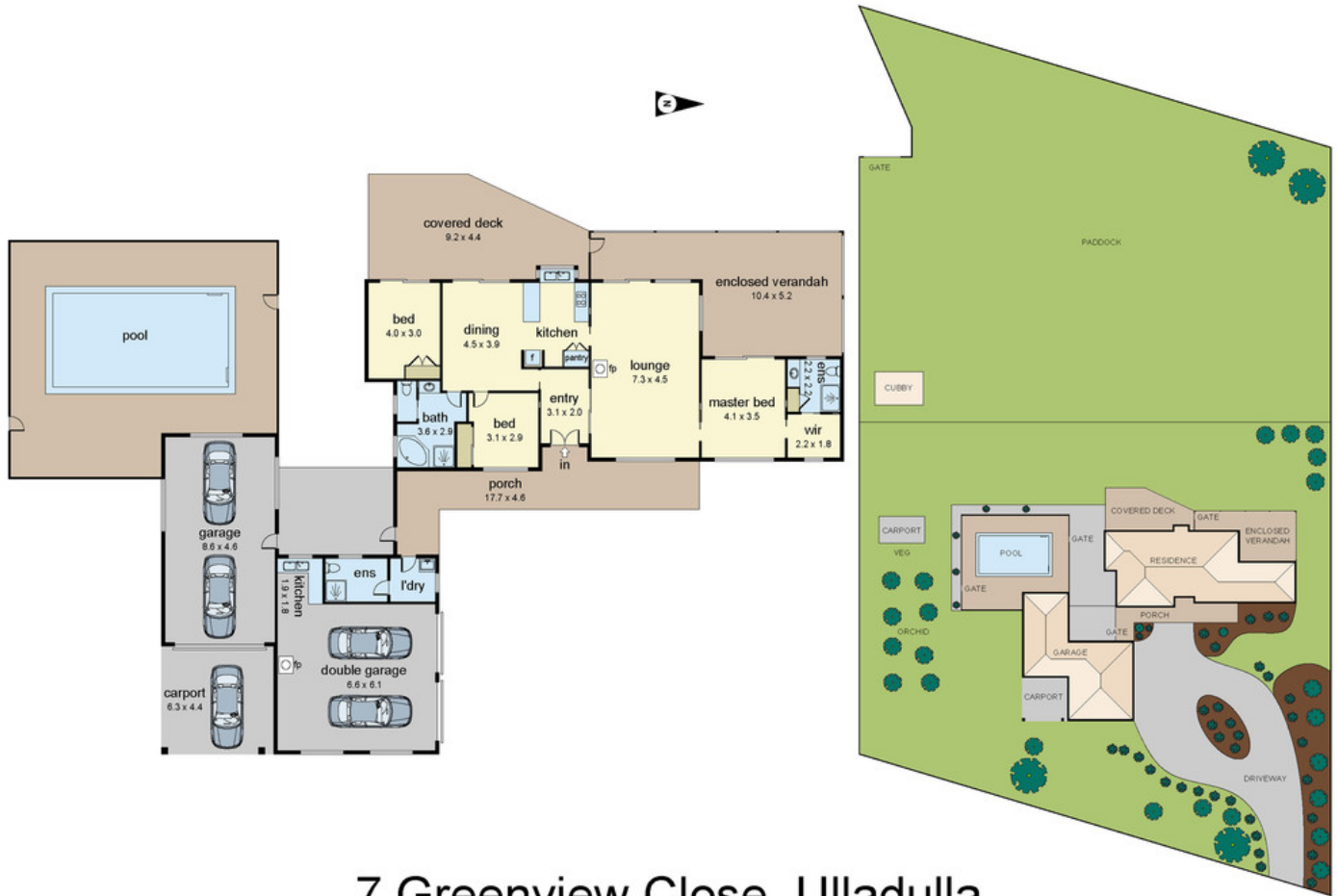

7 Greenview Close, Ulladulla

Approx. Gross internal floor area 2325 sq ft / 216 sq m

This floorplan is a guide only and no warranty is given to its accuracy in dimensions. Purchasers are advised to carry out their own investigations